

尺寸参数
Dimension

型号 Model	外形尺寸 Dimension (mm)			
	长 (L)	宽 (W)	高 (H)	重量 Weight(kg)
BMR224-SM	1600	1100	1750	750
BMR230-SM	1850	1100	1750	850
BMR240-SM	1850	1100	1750	850
BMR250-SM	1700	1100	1750	900
BMR260-SM	1700	1100	1750	900
BMR345-SM	2350	1100	1750	1050
BMR360-SM	2200	1100	1750	1100
BMR375-SM	2700	1200	1750	1300
BMR390-SM	2700	1100	1750	1300
BMR236-SL	1600	1100	1900	900
BMR246-SL	1850	1100	1900	950
BMR354-SL	2350	1100	1900	1200
BMR369-SL	2350	1200	1900	1300
BMR224-SMY	1850	1100	1750	750
BMR230-SMY	1700	1100	1750	900
BMR240-SMY	1700	1100	1750	900
BMR250-SMY	2200	1100	1750	1000
BMR260-SMY	2200	1100	1750	1000
BMR345-SMY	2200	1100	1750	1050
BMR360-SMY	2700	1100	1750	1200
BMR375-SMY	2700	1200	1750	1300
BMR390-SMY	2700	1100	1750	1300
BMR236-SLY	1850	1100	1100	800
BMR246-SLY	1700	1100	1100	950
BMR354-SLY	2400	1100	1100	1200
BMR369-SLY	2400	1100	1100	1200

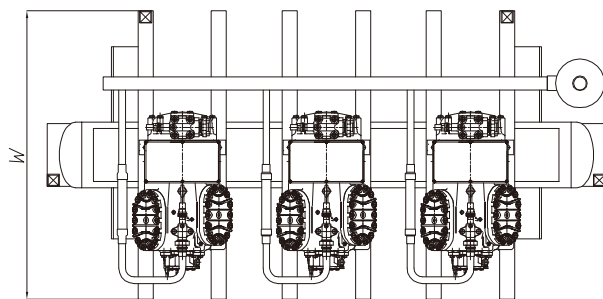
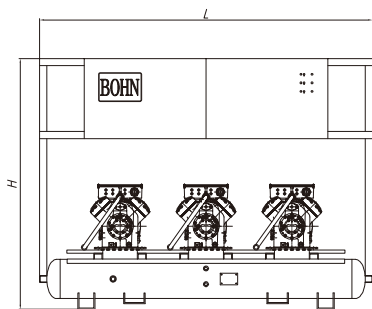

重型活塞并联机组

高效节能

BRR系列

- 低温 36 180HP
- 中低温 56 240HP
- 中高温 105 300HP

BOHN

Heavy Type Hermetic Rack
High Efficiency
BRR Series

市场范围
Market Segments



• 餐饮 Food Service • 超市 Super Market • 冷冻冷藏 Cold Storage

描述
Description

稳定可靠
Stable and Reliable

- 高品质的世界名牌压缩机。
• High quality and world famous compressors.
- 机组中某台压缩机故障时，其他压缩机仍可继续正常工作。
• If one compressor has broken, other compressor also can work continually.
- 每台机组出厂均标配控制器，自动调节压缩机运行时间，延长压缩机使用寿命。
• Standard products are configured controller which can regulate the running time of compressors automaticaly and extend compressor service life.

- 独特的汽液分离设计，最大限度避免液击。
• Special design for suction accumulator can maximize avoiding liquid impact.

高效节能
High efficiency and saving energy

- 控制器在日常部分负荷情况下调整机组最佳运行曲线，为终端用户节省大量电能。
• Controller can adjust compressor on-off in the routine days which saves more electric energy for end-user.

- 精确的管路设计，把管路压力损失减到最小，最大限度提高机组效率。
• Perfect design of pipe minimizes pressure loss along the pipeline which lead to enhance efficiency.

- 可配比不等大小压缩机，提供更多的调节级数，冷量输出可以更加平滑地动态匹配实际负荷。
• Can use different compressors in the same system and balance dynamic cooling capacity output.

结构紧凑灵活
Structure compact and Flexible

- 多台压缩机共享油分离器、冷凝器、储液器、控制系统及框架。
• Share oil separator, condenser, liquid receiver, control system and frame.
- 安装空间的减少可以为大型超市和冷库提供更大的商用空间，进一步为终端用户创造价值。
• Reduce installation space and create more value for end-user.

- 自动化程度高。
• Highly-automated.

- 微电脑控制并联机组实时匹配动态负载，明显降低蒸发压力波动。
• Micro-computer controls the real-time dynamic load which can result in decreasing fluctuation of evaporating pressure.

- 可选用远程监控，自动化运行。
• Through remote monitoring, achieve system running automatically.

命名规则
Nomenclature

BRR系列重型活塞并联机组
BRR SERIES HEAVY TYPE HERMETIC RACK
BRR(1)4(2)136(3)-S(4)L(5)Y(6)-AMLCN(7)

- | | |
|--------------------|------------------------------|
| (1) BRR-大型并联机组重型机架 | BRR:Heavy Type Hermetic Rack |
| (2) 4:压缩机数量 | 4:Compressor No. |
| (3) 136:总匹数 | 136:Total HP |
| (4) S:单级压缩 | S:Single Stage |
| T:双级压缩 | T:Two Stage |
| (5) L:低温 | L:Low Temp |
| M:中温 | M:Middle Temp |
| TL:低温双级 | TL:Two Stage Low Temp |
| (6) 润滑油种类 | Types of oil |
| 空白:矿物油 | Blank:Mineral Oil(R22) |
| Y:聚酯油 | Y:Polyester Oil(R404A,R507A) |
| (7) 选项(单级适用) | Options(Single Stage) |
| A:汽分(低温标配; 中温选配) | A:Suction accumulator |
| M:手动 | M:Manual |
| L:液位报警 | L:Low Liquid Level Alarm |
| C:冷凝器控制 | C:Condenser Control |
| N:标准支路数量 (N-1) | N:Standard branch No.(N-1) |

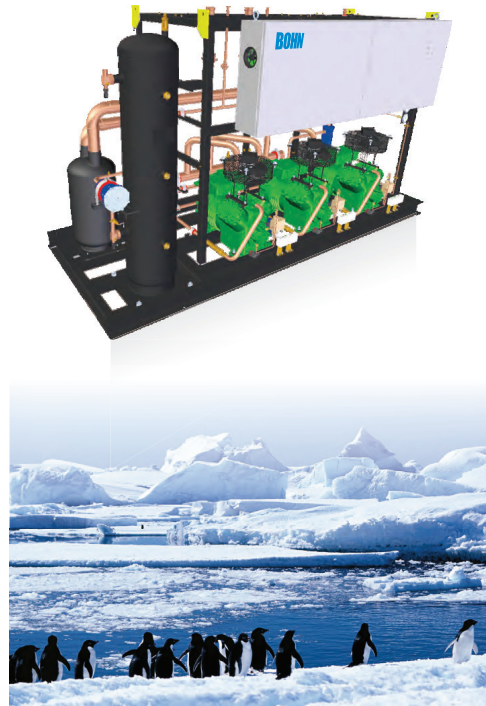

制冷量与输入功率 (R22)
Capacity and Input Power (R22)

中高温
MT&HT

型号 Model	压缩机 Compressor		蒸发温度 SET-15 °C		蒸发温度 SET-10 °C		蒸发温度 SET-5 °C		蒸发温度 SET 0 °C	
	型号 Model	数量 Qty	制冷量 Capacity	功率 Input Power	制冷量 Capacity	功率 Input Power	制冷量 Capacity	功率 Input Power	制冷量 Capacity	功率 Input Power
BRR375-SM-2	4HE-25	3	86.40	39.99	109.20	43.98	136.20	47.58	169.50	50.67
		4	115.20	53.32	145.60	58.64	181.60	63.44	226.00	67.56
		5	144.00	66.65	182.00	73.30	227.00	79.30	282.50	84.45
		6	172.80	79.98	218.40	87.96	272.40	95.16	339.00	101.34
BRR390-SM-2	4GE-30	3	100.80	46.32	127.20	50.79	157.80	54.84	196.50	58.32
		4	134.40	61.76	169.60	67.72	210.40	73.12	262.00	77.76
		5	168.00	77.20	212.00	84.65	263.00	91.40	327.50	97.20
		6	201.60	92.64	254.40	101.58	315.60	109.68	393.00	116.64
BRR270-SM-1	6HE-35	2	86.40	40.00	109.40	44.20	136.00	47.80	169.40	51.00
		3	129.60	60.00	164.10	66.30	204.00	71.70	254.10	76.50
		4	172.80	80.00	218.80	88.40	272.00	95.60	338.80	102.00
		5	216.00	100.00	273.50	110.50	340.00	119.50	423.50	127.50
BRR6210-SM-5	6GE-40	6	259.20	120.00	328.20	132.60	408.00	143.40	508.20	153.00
		2	99.20	46.20	125.40	50.60	156.20	54.80	194.60	58.40
		3	148.80	69.30	188.10	75.90	234.30	82.20	291.90	87.60
		4	198.40	92.40	250.80	101.20	312.40	109.60	389.20	116.80
BRR5200-SM-4	6FE-50	5	248.00	115.50	313.50	126.50	390.50	137.00	486.50	146.00
		6	297.60	138.60	376.20	151.80	468.60	164.40	583.80	175.20
		2	120.00	54.60	151.40	61.80	188.20	66.60	234.20	70.80
		3	180.00	84.60	227.10	92.70	282.30	99.90	351.30	106.20
BRR4200-SM-3		4	240.00	112.80	302.80	123.60	376.40	133.20	468.40	141.60
		5	300.00	141.00	378.50	154.50	470.50	166.50	585.50	177.00
		6	360.00	169.20	454.20	185.40	564.60	199.80	702.60	212.40

机组供电380V/3P/50Hz。名义制冷量及输入功率基于环境温度+38°C，冷凝温度+45°C，制冷剂R22。
Power supply: 380V/3P/50Hz. Nominal cooling capacity and input power are based on ambient temperature +38°C, condensing temperature +45°C and refrigerant R22.
如果机组需运行于不同的蒸发温度或过高/过低的冷凝温度，请联系我们当地代表处。
If the same rack system should be applied in different evaporating temperatures or condensing temperature is out the normal range, please contact our local representative office.
所有的制冷量参数均为净有效值，在考虑了管路损失后仅需对系统加最多10%的余量。
All capacities are net effective valve. If pipe loss is considered in the system, only add 10% capacity.

其他技术参数 (R22)
Other Technical Data (R22)

中高温
MT&HT

型号 Model	匹数 HP	最大工作电流 Max. Operating Current	机组对外管路尺寸 Dimension(mm)			标准支管路球阀数量 No. of Branch Line Ball Valve			电子液位报警 Electronic Liquid Level Alarm	通风量 (Air Flow) m³/h
			排气 Discharge Pipe	吸气 Suction Pipe	供液 Liquid Pipe	排气 Discharge Pipe	吸气 Suction Pipe	供液 Liquid Pipe		
BRR375-SM-2	75	89	54	2'54	2'22	1	2	2	N	7700
BRR4100-SM-3	100	119	54	3'54	3'22	1	3	3	N	10300
BRR5125-SM-4	125	149	67	4'54	4'22	1	4	4	N	12900
BRR6150-SM-5	150	178	67	5'54	5'22	1	5	5	N	15400
BRR390-SM-2	90	105	54	2'67	2'28	1	2	2	N	8900
BRR4120-SM-3	120	140	54	3'67	3'22	1	3	3	N	11900
BRR5150-SM-4	150	175	67	4'54	4'22	1	4	4	N	14900
BRR6180-SM-5	180	210	67	5'54	5'22	1	5	5	N	17900
BRR270-SM-1	70	91	54	79	35	1	1	1	N	7700
BRR3105-SM-2	105	136	54	2'79	2'28	1	2	2	N	11600
BRR4140-SM-3	140	182	67	3'79	3'28	1	3	3	N	15500
BRR5175-SM-4	175	227	67	4'67	4'28	1	4	4	N	19400
BRR6210-SM-5	210	272	79	5'67	5'28	1	5	5	N	23200
BRR280-SM-1	80	108	54	89	35	1	1	1	N	8800
BRR3120-SM-2	120	162	67	2'79	2'28	1	2	2	N	13300
BRR4160-SM-3	160	216	67	3'79	3'28	1	3	3	N	17700
BRR5200-SM-4	200	270	79	4'67	4'28	1	4	4	N	22200
BRR6240-SM-5	240	323	79	5'67	5'28	1	5	5	N	26600
BRR2100-SM-1	100	146	54	108	35	1	1	1	N	10700
BRR3150-SM-2	150	219	67	2'89	2'28	1	2	2	N	16100
BRR4200-SM-3	200	292	79	3'79	3'28	1	3	3	N	21500
BRR5250-SM-4	250	366	79	4'79	4'28	1	4	4	N	26900
BRR6300-SM-5	300	439	79	5'79	5'28	1	5	5	N	32300

所有机组对外管路尺寸可根据客户需求定制。
All pipe sizes of rack systems can be customized by customer's requirement, such as liquid pipe and suction pipe.
所有标准机组 (R22) 预先充注矿物油，R404A机组预先充注聚酯油。
All rack system using R22 should be charged mineral oil in advance, otherwise polyester.

制冷量与输入功率 (R22)
Capacity and Input Power (R22)

型号 Model	压缩机 Compressor		蒸发温度 SET-40°C		蒸发温度 SET-35°C		蒸发温度 SET-30°C		蒸发温度 SET-25°C		蒸发温度 SET-20°C	
	型号 Model	数量 Qty	制冷量 Capacity	功率 Input Power	制冷量 Capacity	功率 Input Power	制冷量 Capacity	功率 Input Power	制冷量 Capacity	功率 Input Power	制冷量 Capacity	功率 Input Power
BRR354-SL-A2	3	16.11	17.55	24.96	22.23	35.79	26.76	48.90	31.26	66.30	35.34	
BRR472-SL-A3	4	21.48	23.40	33.28	29.64	47.72	35.68	65.20	41.68	88.40	47.12	
BRR590-SL-A4	5	26.85	29.25	41.60	37.05	59.65	44.60	81.50	52.10	110.50	58.90	
BRR6108-SL-A5	6	32.22	35.10	49.92	44.46	71.58	53.52	97.80	62.52	132.60	70.68	
BRR369-SL-A2	3	15.84	21.30	29.13	26.85	41.61	32.31	56.73	37.47	79.80	42.96	
BRR492-SL-A3	4	21.12	28.40	38.84	35.80	55.48	43.08	75.64	49.96	106.40	57.28	
BRR5115-SL-A4	5	26.40	35.50	48.55	44.75	69.35	53.85	94.55	62.45	133.00	71.60	
BRR6138-SL-A5	6	31.68	42.60	58.26	53.70	83.22	64.62	113.46	74.94	159.60	85.92	
BRR256-SL-A1	2	16.12	17.48	24.96	22.16	35.78	26.74	48.80	31.22	68.00	36.20	
BRR384-SL-A2	3	24.18	26.22	37.44	33.24	53.67	40.11	73.20	46.83	102.00	54.30	
BRR4112-SL-A3	4	32.24	34.96	49.92	44.32	71.56	53.48	97.60	62.44	136.00	72.40	
BRR5140-SL-A4	5	40.30	43.70	62.40	55.40	89.45	66.85	122.00	78.05	170.00	90.50	
BRR6168-SL-A5	6	48.36	52.44	74.88	66.48	107.34	80.22	146.40	93.66	204.00	108.60	
BRR268-SL-A1	2	18.82	21.28	29.12	26.82	41.60	32.26	56.80	37.44	78.60	42.20	
BRR3102-SL-A2	3	28.23	31.92	43.68	40.23	62.40	48.39	85.20	56.16	117.90	63.30	
BRR4136-SL-A3	4	37.64	42.56	58.24	53.64	83.20	64.52	113.60	74.88	157.20	84.40	
BRR5170-SL-A4	5	47.05	53.20	72.80	67.05	104.00	80.65	142.00	93.60	196.50	105.50	
BRR6204-SL-A5	6	56.46	63.84	87.36	80.46	124.80	96.78	170.40	112.32	235.80	126.60	
BRR288-SL-A1	2	23.46	25.96	35.72	32.38	50.60	38.84	68.40	45.20	95.20	51.20	
BRR3132-SL-A2	3	35.19	38.94	53.58	48.57	75.90	58.26	102.60	67.80	142.80	76.80	
BRR4176-SL-A3	4	46.92	51.92	71.44	64.76	101.20	77.68	136.80	90.40	190.40	102.40	
BRR5220-SL-A4	5	58.65	64.90	89.30	80.95	126.50	97.10	171.00	113.00	238.00	128.00	
BRR6264-SL-A5	6	70.38	77.88	107.16	97.14	151.80	116.52	205.20	135.60	285.60	153.60	

机组供电380V/3P/50Hz。名义制冷量及输入功率基于环境温度+38°C、冷凝温度+45°C、制冷剂R22。
Power supply: 380V/3P/50Hz. Nominal cooling capacity and input power are based on ambient temperature +38°C, condensing temperature +45°C and refrigerant R22.
如果机组需要运行于不同的蒸发温度或过高的/过低的冷凝温度，请联系我们当地代表处。
If the same rack system should be applied in different evaporating temperatures or condensing temperature is out the normal range, please contact our local representative office.
所有的制冷量参数均为净有效值。在考虑了管路损失后仅需对系统加最多10%的余量。
All capacities are net effective valve. If pipe lose is considered in the system, only add 10% capacity.

其他技术参数 (R22)
Other Technical Data (R22)

型号 Model	匹数 HP	最大工作电流 Max. Operating Current	机组对外管路尺寸 Dimension(mm)			标准支管路球阀数量 No. of Branch Line Ball Valve			电子液位报警 Electronic/Liquid Level Alarm	通风量 (Air Flow) m³/h
			排气 Discharge Pipe	吸气 Suction Pipe	供液 Liquid Pipe	排气 Discharge Pipe	吸气 Suction Pipe	供液 Liquid Pipe		
BRR354-SL-A2	54	63	28	2'5.4	2'16	1	2	2	N	2300
BRR472-SL-A3	72	84	35	3'5.4	3'12	1	3	3	N	3100
BRR590-SL-A4	90	105	35	4'5.4	4'12	1	4	4	N	3900
BRR6108-SL-A5	108	125	35	5'5.4	5'12	1	5	5	N	4700
BRR369-SL-A2	69	74	28	2'5.4	2'16	1	2	2	N	2800
BRR492-SL-A3	92	98	35	3'5.4	3'16	1	3	3	N	3700
BRR5115-SL-A4	115	123	42	4'5.4	4'16	1	4	4	N	4700
BRR6138-SL-A5	138	148	42	5'5.4	5'16	1	5	5	N	5600
BRR256-SL-A1	56	66	28	79	22	1	1	1	N	2300
BRR384-SL-A2	84	99	35	2'5.4	2'16	1	2	2	N	3500
BRR4112-SL-A3	112	132	42	3'6.7	3'16	1	3	3	N	4700
BRR5140-SL-A4	140	166	42	4'5.4	4'16	1	4	4	N	5900
BRR6168-SL-A5	168	199	54	5'5.4	5'16	1	5	5	N	7100
BRR268-SL-A1	68	75	28	79	22	1	1	1	N	2800
BRR3102-SL-A2	102	113	35	2'6.7	2'22	1	2	2	N	4200
BRR4136-SL-A3	136	150	42	3'6.7	3'22	1	3	3	N	5600
BRR5170-SL-A4	170	188	54	4'6.7	4'16	1	4	4	N	7000
BRR6204-SL-A5	204	225	54	5'6.7	5'16	1	5	5	N	8400
BRR288-SL-A1	88	98	35	79	22	1	1	1	N	3400
BRR3132-SL-A2	132	148	42	2'7.9	2'22	1	2	2	N	5100
BRR4176-SL-A3	176	197	54	3'6.7	3'22	1	3	3	N	6800
BRR5220-SL-A4	220	246	54	4'6.7	4'22	1	4	4	N	8600
BRR6264-SL-A5	264	295	54	5'6.7	5'22	1	5	5	N	10300

所有机组对外管路尺寸可根据客户需求定制。
All pipe sizes of rack systems can be customized by customer's requirement, such as liquid pipe and suction pipe.
所有标准机组 (R22) 预先充注矿物油, 404A机组预先充注聚酯油。
All rack system using R22 should be charged mineral oil in advance, otherwise polyester.

中低温
MT<

制冷量与输入功率 (R404A)
Capacity and Input Power (R404A)

型号 Model	压缩机 Compressor		蒸发温度 SET-40°C		蒸发温度 SET-35°C		蒸发温度 SET-30°C		蒸发温度 SET-25°C		蒸发温度 SET-20°C	
	型号 Model	数量 Qty	制冷量 Capacity	功率 Input Power	制冷量 Capacity	功率 Input Power	制冷量 Capacity	功率 Input Power	制冷量 Capacity	功率 Input Power	制冷量 Capacity	功率 Input Power
BRR354-SLY-A2	3	18.66	21.69	27.00	26.25	37.35	31.05	50.07	36.00	65.40	40.98	
BRR472-SLY-A3	4	24.88	28.92	36.00	35.00	49.80	41.40	66.76	48.00	87.20	54.64	
BRR590-SLY-A4	5	31.10	36.15	45.00	43.75	62.25	51.75	83.45	60.00	109.00	68.30	
BRR6108-SLY-A5	6	37.32	43.38	54.00	52.50	74.70	62.10	100.14	72.00	130.80	81.96	
BRR369-SLY-A2	3	23.07	26.13	32.61	31.38	44.46	36.99	59.01	42.81	76.80	48.72	
BRR492-SLY-A3	4	30.76	34.84	43.48	41.84	59.28	49.32	78.68	57.08	102.40	64.96	
BRR5115-SLY-A4	5	38.45	43.55	54.35	52.30	74.10	61.65	98.35	71.35	128.00	81.20	
BRR6138-SLY-A5	6	46.14	52.26	65.22	62.76	88.92	73.98	118.02	85.62	153.60	97.44	
BRR256-SLY-A1	2	18.34	20.80	26.50	25.50	36.68	30.40	49.20	35.38	64.20	40.40	
BRR384-SLY-A2	3	27.51	31.20	39.75	38.25	55.02	45.60	73.80	53.07	96.30	60.60	
BRR4112-SLY-A3	4	36.68	41.60	53.00	51.00	73.36	60.80	98.40	70.76	128.40	80.80	
BRR5140-SLY-A4	5	45.85	52.00	66.25	63.75	91.70	76.00	123.00	88.45	160.50	101.00	
BRR6168-SLY-A5	6	55.02	62.40	79.50	76.50	110.04	91.20	147.60	106.14	192.60	121.20	
BRR268-SLY-A1	2	23.82	27.12	33.36	32.38	45.20	37.90	59.40	43.60	76.60	49.20	
BRR3102-SLY-A2	3	35.73	40.68	50.04	48.57	67.80	56.85	89.10	65.40	114.90	73.80	
BRR4136-SLY-A3	4	47.64	54.24	66.72	64.76	90.40	75.80	118.80	87.20	153.20	98.40	
BRR5170-SLY-A4	5	59.55	67.80	83.40	80.95	113.00	94.75	148.50	109.00	191.50	123.00	
BRR6204-SLY-A5	6	71.46	81.36	100.08	97.14	135.60	113.70	178.20	130.80	229.80	147.60	
BRR288-SLY-A1	2	27.22	32.14	38.92	38.70	53.20	45.40	70.60	52.40	91.40	59.20	
BRR3132-SLY-A2	3	40.83	48.21	58.38	58.05	79.80	68.10	105.90	78.60	137.10	88.80	
BRR4176-SLY-A3	4	54.44	64.28	77.84	77.40	106.40	90.80	141.20	104.80	182.80	118.40	
BRR5220-SLY-A4	5	68.05	80.35	97.30	96.75	133.00	113.50	176.50	131.00	228.50	148.00	
BRR6264-SLY-A5	6	81.66	96.42	116.76	116.10	159.60	136.20	211.80	157.20	274.20	177.60	

机组供电380V/3P/50Hz。名义制冷量及输入功率基于环境温度+38°C、冷凝温度+45°C、制冷剂R404A。
Power supply: 380V/3P/50Hz. Nominal cooling capacity and input power are based on ambient temperature +38°C, condensing temperature +45°C and refrigerant R404A.
如果机组需要运行于不同的蒸发温度或过高的/过低的冷凝温度，请联系我们当地代表处。
If the same rack system should be applied in different evaporating temperatures or condensing temperature is out the normal range, please contact our local representative office.
所有的制冷量参数均为净有效值。在考虑了管路损失后仅需对系统加最多10%的余量。
All capacities are net effective valve. If pipe lose is considered in the system, only add 10% capacity.

其他技术参数 (R404A)
Other Technical Data (R404A)

型号 Model	匹数 HP	最大工作电流 Max. Operating Current	机组对外管路尺寸 Dimension(mm)			标准支管路球阀数量 No. of Branch Line Ball Valve			电子液位报警 Electronic/Liquid Level Alarm	通风量 (Air Flow) m³/h
			排气 Discharge Pipe	吸气 Suction Pipe	供液 Liquid Pipe	排气 Discharge Pipe	吸气 Suction Pipe	供液 Liquid Pipe		
BRR354-SLY-A2	54	71	35	2'5.4	2'22	1	2	2	N	2300
BRR472-SLY-A3	72	94	35	3'5.4	3'22	1	3	3	N	3100
BRR590-SLY-A4	90	118	42	4'5.4	4'22	1	4	4	N	3900
BRR6108-SLY-A5	108	142	42	5'5.4	5'16	1	5	5	N	4700
BRR369-SLY-A2	69	83	35	2'5.4	2'22	1	2	2	N	2800
BRR492-SLY-A3	92	110	42	3'5.4	3'22	1	3	3	N	3700
BRR5115-SLY-A4	115	138	42	4'5.4	4'22	1	4	4	N	4700
BRR6138-SLY-A5	138	165	54	5'5.4	5'22	1	5	5	N	5600
BRR256-SLY-A1	56	72	35	79	28	1	1	1	N	2300
BRR384-SLY-A2	84	108	42	2'6.7	2'22	1	2	2	N	3500
BRR4112-SLY-A3	112	144	42	3'6.7	3'22	1	3	3	N	4700
BRR5140-SLY-A4	140	181	54	4'5.4	4'22	1	4	4	N	5900
BRR6168-SLY-A5	168	217	54	5'5.4	5'22	1	5	5	N	7100
BRR268-SLY-A1	68	85	35	79	28	1	1	1	N	2800
BRR3102-SLY-A2	102	128	42	2'6.7	2'28	1	2	2	N	4200
BRR4136-SLY-A3	136	171	54	3'6.7	3'22	1	3	3	N	5600
BRR5170-SLY-A4	170	214	54	4'6.7	4'22	1	4	4	N	7000
BRR6204-SLY-A5	204	256	54	5'6.7	5'22	1	5	5	N	8400
BRR288-SLY-A1	88	109	42	79	28	1	1	1	N	3400
BRR3132-SLY-A2	132	163	54	2'7.9	2'28	1	2	2	N	5100
BRR4176-SLY-A3	176	218	54	3'6.7	3'28	1	3	3	N	6800
BRR5220-SLY-A4	220	272	54	4'6.7	4'22	1	4	4	N	8600
BRR6264-SLY-A5	264	326	67	5'6.7	5'22	1	5	5	N	1030

制冷量与输入功率 (R404A)
Capacity and Input Power (R404A)

中高温
MT&HT

型号 Model	压缩机 Compressor		蒸发温度 SET-15°C		蒸发温度 SET-10°C		蒸发温度 SET-5°C		蒸发温度 SET0°C	
	型号 Model	数量 Qty	制冷量 Capacity	功率 Input Power	制冷量 Capacity	功率 Input Power	制冷量 Capacity	功率 Input Power	制冷量 Capacity	功率 Input Power
BRR375-SMY-2		3	82.20	44.10	104.40	48.57	130.50	52.77	168.60	56.61
BRR4100-SMY-3	4HE-25Y	4	109.60	58.80	139.20	64.76	174.00	70.36	224.80	75.48
BRR5125-SMY-4		5	137.00	73.50	174.00	80.95	217.50	87.95	281.00	94.35
BRR6150-SMY-5		6	164.40	88.20	208.80	97.14	261.00	105.54	337.20	113.22
BRR390-SMY-2		3	94.80	50.97	119.70	56.13	149.70	60.90	192.90	65.40
BRR4120-SMY-3	4GE-30Y	4	126.40	67.96	159.60	74.84	199.60	81.20	257.20	87.20
BRR5150-SMY-4		5	158.00	84.95	199.50	93.55	249.50	101.50	321.50	109.00
BRR6180-SMY-5		6	189.60	101.94	239.40	112.26	299.40	121.80	385.80	130.80
BRR270-SMY-1		2	80.60	44.00	102.20	48.40	127.80	52.20	165.00	55.80
BRR3105-SMY-2		3	120.90	66.00	153.30	72.60	191.70	78.30	247.50	83.70
BRR4140-SMY-3	6HE-35Y	4	161.20	88.00	204.40	96.80	255.60	104.40	330.00	111.60
BRR5175-SMY-4		5	201.50	110.00	255.50	121.00	319.50	130.50	412.50	139.50
BRR6210-SMY-5		6	241.80	132.00	306.60	145.20	383.40	156.60	495.00	167.40
BRR280-SMY-1		2	92.40	51.20	116.40	56.00	145.20	60.60	186.60	64.60
BRR3120-SMY-2		3	138.60	76.80	174.60	84.00	217.80	90.90	279.90	96.90
BRR4160-SMY-3	6GE-40Y	4	184.80	102.40	232.80	112.00	290.40	121.20	373.20	129.20
BRR5200-SMY-4		5	231.00	128.00	291.00	140.00	363.00	151.50	466.50	161.50
BRR6240-SMY-5		6	277.20	153.60	349.20	168.00	435.60	181.80	559.80	193.80
BRR2100-SMY-1		2	113.00	63.00	142.20	69.20	176.80	75.00	227.00	80.20
BRR3150-SMY-2		3	169.50	94.50	213.30	103.80	265.20	112.50	340.50	120.30
BRR4200-SMY-3		4	226.00	126.00	284.40	138.40	353.60	150.00	454.00	160.40
BRR5250-SMY-4	6FE-50Y	5	282.50	157.50	355.50	173.00	442.00	187.50	567.50	200.50
BRR6300-SMY-5		6	339.00	189.00	426.60	207.60	530.40	225.00	681.00	240.60

机组供电380V/3P/50Hz, 名义制冷量及输入功率基于环境温度+38°C, 冷凝温度+45°C, 制冷剂R404A.

Power supply: 380V/3P/50Hz. Nominal cooling capacity and input power are based on ambient temperature +38°C, condensing temperature +45°C and refrigerant R404A.

如果机组需要运行于不同的蒸发温度或过高/过低的冷凝温度, 请联系我们当地代表处。

If the same rack system should be applied in different evaporating temperatures or condensing temperature is out the normal range, please contact our local representative office.

所有的制冷量参数为均净有效值, 在考虑了管路损失后仅需对系统加最多10%的余量。

All capacities are net effective value. If pipe loss is considered in the system, only add 10% capacity.

其他技术参数 (R404A)
Other Technical Data (R404A)

低温双级
LT Two Stage

型号 Model	匹数 HP	最大工作电流 Max. Operating Current	机组对外管路尺寸 Dimension(mm)			标准支管路球阀数量 No. of Branch Line Ball Valve			电子低液位报警 Electronic Liquid Level Alarm	通风量 (Air Flow) m³/h
			排气 Discharge Pipe	吸气 Suction Pipe	供液 Liquid Pipe	排气 Discharge Pipe	吸气 Suction Pipe	供液 Liquid Pipe		
		A	mm	mm	mm				有Y/无N	
BRR375-SMY-2	75	98	54	2*54	2*28	1	2	2	N	7700
BRR4100-SMY-3	100	130	54	3*54	3*28	1	3	3	N	10300
BRR5125-SMY-4	125	163	67	4*54	4*28	1	4	4	N	12900
BRR6150-SMY-5	150	196	67	5*54	5*28	1	5	5	N	15400
BRR390-SMY-2	90	116	54	2*67	2*28	1	2	2	N	8900
BRR4120-SMY-3	120	154	67	3*67	3*28	1	3	3	N	11900
BRR5150-SMY-4	150	193	67	4*54	4*28	1	4	4	N	14900
BRR6180-SMY-5	180	231	67	5*54	5*28	1	5	5	N	17900
BRR270-SMY-1	70	98	54	79	42	1	1	1	N	7700
BRR3105-SMY-2	105	147	67	2*79	2*35	1	2	2	N	11600
BRR4140-SMY-3	140	196	67	3*67	3*35	1	3	3	N	15500
BRR5175-SMY-4	175	245	79	4*67	4*35	1	4	4	N	19400
BRR6210-SMY-5	210	293	79	5*67	5*28	1	5	5	N	23200
BRR280-SMY-1	80	116	54	89	42	1	1	1	N	8800
BRR3120-SMY-2	120	174	67	2*79	2*35	1	2	2	N	13300
BRR4160-SMY-3	160	232	67	3*79	3*35	1	3	3	N	17700
BRR5200-SMY-4	200	291	79	4*67	4*35	1	4	4	N	22200
BRR6240-SMY-5	240	349	79	5*67	5*35	1	5	5	N	26600
BRR2100-SMY-1	100	157	54	108	54	1	1	1	N	10700
BRR3150-SMY-2	150	235	67	2*89	2*42	1	2	2	N	16100
BRR4200-SMY-3	200	314	79	3*79	3*35	1	3	3	N	21500
BRR5250-SMY-4	250	392	79	4*79	4*35	1	4	4	N	26900
BRR6300-SMY-5	300	470	79	5*79	5*35	1	5	5	N	32300

所有机组对外管路尺寸可根据客户需求定制。

All pipe sizes of rack systems can be customized by customer's requirement, such as liquid pipe and suction pipe.

所有标准机组 (R22) 预先充注矿物油, R404A机组预先充注聚酯油。

All rack system using R22 should be charged mineral oil in advance, otherwise polyester.

制冷量与输入功率 (R22)
Capacity and Input Power (R22)

低温双级
LT Two Stage

型号 Model	压缩机 Compressor		蒸发温度 SET-45°C		蒸发温度 SET-40°C		蒸发温度 SET-35°C		蒸发温度 SET-30°C		蒸发温度 SET-25°C	
	型号 Model	数量 Qty	制冷量 Capacity	功率 Input Power	制冷量 Capacity	功率 Input Power	制冷量 Capacity	功率 Input Power	制冷量 Capacity	功率 Input Power	制冷量 Capacity	功率 Input Power
BRR336-TL	S4G-122	3	19.53	20.67	25.77	23.04	32.79	25.38	40.74	27.75	49.71	30.12
BRR348-TL	S4J-162	3	29.43	27.51	38.76	31.74	48.96	35.91	60.30	40.05	72.90	44.19
BRR360-TL	S6H-202	3	34.11	31.89	44.94	36.78	56.76	41.61	69.90	46.41	84.60	51.21
BRR390-TL	S6F-302	3	46.86	43.80	61.80	50.52	78.00	57.15	96.00	63.60	116.10	70.20
BRR480-TL	S6H-202	4	45.48	42.52	59.92	49.04	75.68	55.48	93.20	61.88	112.80	68.28
BRR4100-TL	S6G-252	4	52.24	48.80	68.80	56.28	86.80	63.68	106.80	71.04	129.20	78.40
BRR4120-TL	S6F-302	4	62.48	58.40	82.40	67.36	104.00	76.20	128.00	84.80	154.80	93.60
BRR5150-TL	S6F-302	5	78.10	73.00	103.00	84.20	130.00	95.25	160.00	106.00	193.50	117.00
BRR6180-TL	S6F-302	6	93.72	87.60	123.60	101.04	156.00	114.30	192.00	127.20	232.20	140.40

机组供电380V/3P/50Hz, 名义制冷量及输入功率基于环境温度+38°C, 冷凝温度+45°C, 制冷剂R22.

Power supply: 380V/3P/50Hz. Nominal cooling capacity and input power are based on ambient temperature +38°C, condensing temperature +45°C and refrigerant R22.

如果机组需要运行于不同的蒸发温度或过高/过低的冷凝温度, 请联系我们当地代表处。

If the same rack system should be applied in different evaporating temperatures or condensing temperature is out the normal range, please contact our local representative office.

所有的制冷量参数为均净有效值, 在考虑了管路损失后仅需对系统加最多10%的余量。

All capacities are net effective value. If pipe loss is considered in the system, only add 10% capacity.

其他技术参数 (R22)
Other Technical Data (R22)

低温双级
LT Two Stage

型号 Model	匹数 HP	最大工作电流 Max. Operating Current	机组对外管路尺寸 Dimension(mm)			标准支管路球阀数量 No. of Branch Line Ball Valve			电子低液位报警 Electronic Liquid Level Alarm	通风量 (Air Flow) m³/h
			排气 Discharge Pipe	吸气 Suction Pipe	供液 Liquid Pipe	排气 Discharge Pipe	吸气 Suction Pipe	供液 Liquid Pipe		
		A	mm	mm	mm				有Y/无N	
BRR336-TL	36	53	35	54	22	1	1	1	N	3000
BRR348-TL	48	73	35	67	22	1	1	1	N	4600
BRR360-TL	60	85	35	2*54	2*16	1	2	2	N	5200
BRR390-TL	90	118	42	3*54	3*16	1	3	3	N	7000
BRR480-TL	80	113	42	3*54	3*16	1	3	3	N	7000
BRR4100-TL	100	130	54	3*54	3*22	1	3	3	N	8000
BRR4120-TL	120	158	54	3*67	3*22	1	3	3	N	9600
BRR5150-TL	150	197	54	4*67	4*22	1	4	4	N	12000
BRR6180-TL	180	236	54	5*67	5*22	1	5	5	N	14400

所有机组对外管路尺寸可根据客户需求定制。

All pipe sizes of rack systems can be customized by customer's requirement, such as liquid pipe and suction pipe.

所有标准机组 (R22) 预先充注矿物油, R404A机组预先充注聚酯油。

All rack system using R22 should be charged mineral oil in advance, otherwise polyester.

机组对外管路数据为标准支路规格。

The date of pipe is branch line.



制冷量与输入功率 (R404A)
Capacity and Input Power (R404A)

型号 Model	压缩机 Compressor		蒸发温度 SET-45°C		蒸发温度 SET-40°C		蒸发温度 SET-35°C		蒸发温度 SET-30°C		蒸发温度 SET-25°C	
	型号 Model	数量 Qty	制冷量 Capacity	功率 Input Power	制冷量 Capacity	功率 Input Power	制冷量 Capacity	功率 Input Power	制冷量 Capacity	功率 Input Power	制冷量 Capacity	功率 Input Power
BRR336-TLY	S4G-122Y	3	24.78	24.00	30.78	26.88	37.62	29.70	45.33	32.46	53.94	35.10
BRR348-TLY	S4J-162Y	3	34.92	33.63	43.14	37.68	52.44	41.88	63.00	46.26	74.40	50.82
BRR360-TLY	S6F-202Y	3	40.29	38.97	49.74	43.65	60.30	48.51	72.30	53.55	85.80	58.80
BRR390-TLY	S6F-302Y	3	54.60	53.55	67.20	59.94	81.60	66.60	97.50	73.20	115.50	79.80
BRR480-TLY	S8H-202Y	4	53.72	51.96	66.32	58.20	80.40	64.68	96.40	71.40	114.40	78.40
BRR4100-TLY	S6G-252Y	4	61.36	59.68	75.68	66.80	92.00	74.24	110.00	82.00	130.40	90.00
BRR4120-TLY	S6F-302Y	4	72.80	71.40	89.60	79.92	108.80	88.80	130.00	97.60	154.00	106.40
BRR5150-TLY	S6F-302Y	5	91.00	89.25	112.00	99.90	136.00	111.00	162.50	122.00	192.50	133.00
BRR6180-TLY	S6F-302Y	6	109.20	107.10	134.40	119.88	163.20	133.20	195.00	146.40	231.00	159.60

机组供电380V/3P/50Hz, 名义制冷量及输入功率基于环境温度+38°C, 冷凝温度+45°C, 制冷剂R404A。
Power supply: 380V/3P/50Hz, Nominal cooling capacity and input power are based on ambient temperature +38°C, condensing temperature +45°C and refrigerant R404A.
如果机组需要运行于不同的蒸发温度或过高的/过低的冷凝温度, 请联系我们当地代表处。
If the same rack system should be applied in different evaporating temperatures or condensing temperature is out the normal range, please contact our local representative office.
所有的制冷量参数为均净有效值, 在考虑了管路损失后仅需对系统加最多10%的余量。
All capacities are net effective value. If pipe loss is considered in the system, only add 10% capacity.

其他技术参数 (R404A)
Other Technical Data (R404A)

型号 Model	匹数 HP	最大工作电流 Max. Operating Current	机组对外管路尺寸 Dimension(mm)			标准支管路球阀数量 No. of Branch Line Ball Valve			电子液位报警 Electronic Liquid Level Alarm	通风量 (Air Flow) m³/h
			排气 Discharge Pipe	吸气 Suction Pipe	供液 Liquid Pipe	排气 Discharge Pipe	吸气 Suction Pipe	供液 Liquid Pipe		
			A	A	A	有Y/无N				
BRR336-TLY	36	59	35	67	35	1	1	1	N	3000
BRR348-TLY	48	83	42	79	35	1	1	1	N	4600
BRR360-TLY	60	95	42	2*67	2*28	1	2	2	N	5200
BRR390-TLY	90	131	54	2*67	2*35	1	3	3	N	7000
BRR480-TLY	80	127	54	3*54	3*28	1	3	3	N	7000
BRR4100-TLY	100	147	54	3*54	3*28	1	3	3	N	8000
BRR4120-TLY	120	175	54	3*67	3*28	1	3	3	N	9600
BRR5150-TLY	150	219	67	4*67	4*28	1	4	4	N	12000
BRR6180-TLY	180	263	67	5*67	5*28	1	5	5	N	14400

所有机组对外管路尺寸可根据客户需求定制。
All pipe sizes of rack systems can be customized by customer's requirement, such as liquid pipe and suction pipe.
所有标准机组 (R22) 预先充注矿物油, R404A机组预先充注聚酯油。
All rack system using R22 should be charged mineral oil in advance, otherwise polyester.
机组对外管路数据为标准支路规格。
The dimension data based on standard condition.

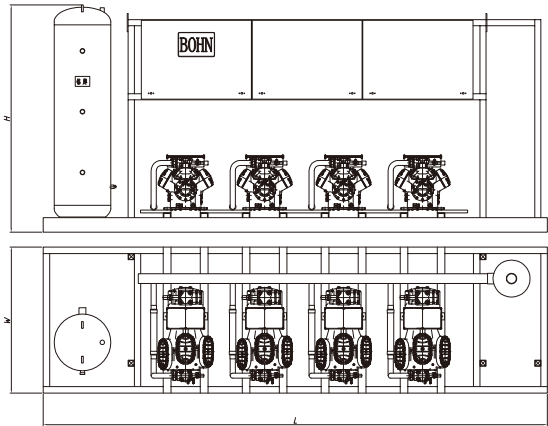

低温双级
LT Two Stage

低温双级
LT Two Stage

尺寸参数
Dimension

型号 Model	外形尺寸 Dimension (mm)			
	长(L)	宽(W)	高(H)	重量 Weight (kg)
BRR375-SM-2	3105	1200	1770	2000
BRR4100-SM-3	3755	1200	1770	2000
BRR5125-SM-4	4415	1200	1940	2400
BRR6150-SM-5	5065	1200	1940	3000
BRR390-SM-2	3105	1200	1770	2000
BRR4120-SM-3	3755	1200	1770	2000
BRR5150-SM-4	4415	1200	1940	2400
BRR6180-SM-5	5065	1200	1940	3000
BRR270-SM-1	2455	1200	1770	1600
BRR3105-SM-2	3105	1200	1825	2000
BRR4140-SM-3	3765	1200	1940	2350
BRR5175-SM-4	4755	1200	1770	3000
BRR6210-SM-5	5405	1200	1900	2800
BRR280-SM-1	2455	1200	1770	1600
BRR3120-SM-2	3115	1200	1940	2000
BRR4160-SM-3	3765	1200	1990	2350
BRR5200-SM-4	4755	1200	1990	3000
BRR6240-SM-5	5045	1200	1990	2800
BRR2100-SM-1	2455	1200	1770	1600
BRR3150-SM-2	3115	1200	1940	2000
BRR4200-SM-3	4105	1200	1990	2350
BRR5250-SM-4	4805	1200	1990	3000
BRR6300-SM-5	5455	1200	1990	2800
BRR354-SL-A2	3105	1200	1770	2000
BRR472-SL-A3	3750	1200	1770	2350
BRR590-SL-A4	4405	1200	1770	3000
BRR6108-SL-A5	5055	1200	1770	3000
BRR369-SL-A2	3100	1200	1770	2000
BRR492-SL-A3	3750	1200	1770	2400
BRR5115-SL-A4	4405	1200	1770	2400
BRR6138-SL-A5	5055	1200	1770	3000
BRR256-SL-A1	2455	1200	1770	1600
BRR384-SL-A2	3100	1200	1770	2000
BRR4112-SL-A3	3755	1200	1770	2000
BRR5140-SL-A4	4405	1400	1770	2400
BRR6168-SL-A5	5065	1400	1770	3000
BRR268-SL-A1	2455	1200	1755	1600
BRR3102-SL-A2	3105	1200	1770	1600
BRR4136-SL-A3	3755	1200	1770	2000
BRR5170-SL-A4	4415	1400	1940	2400
BRR6204-SL-A5	5065	1400	1940	3000
BRR288-SL-A1	2450	1200	1755	1600
BRR3132-SL-A2	3105	1200	1825	2000
BRR4176-SL-A3	3755	1400	1770	2350
BRR5220-SL-A4	4415	1400	1940	3000
BRR6264-SL-A5	5065	1400	1940	2800
BRR336-TL	3700	1200	1800	1400
BRR348-TL	3700	1200	1800	1500
BRR360-TL	3700	1200	1800	1550
BRR390-TL	3700	1200	1800	1600
BRR480-TL	4450	1200	1800	1950
BRR4100-TL	4450	1300	1800	2000
BRR4120-TL	4450	1200	1800	2000
BRR5150-TL	5250	1300	1950	2500
BRR6180-TL	5950	1400	1850	2850

尺寸参数
Dimension

型号 Model	外形尺寸 Dimension (mm)			
	长(L)	宽(W)	高(H)	重量 Weight (kg)
BRR354-SLY-A2	3105	1200	1760	2000
BRR472-SLY-A3	3750	1200	1700	2350
BRR590-SLY-A4	4405	1200	1770	3000
BRR6108-SLY-A5	5065	1200	1940	3000
BRR369-SLY-A2	3105	1200	1770	2000
BRR492-SLY-A3	3750	1200	1770	2400
BRR5115-SLY-A4	4415	1200	1940	2400
BRR6138-SLY-A5	5065	1200	1940	3000
BRR256-SLY-A1	2450	1200	1755	1600
BRR384-SLY-A2	3105	1200	1770	2000
BRR4112-SLY-A3	3755	1200	1770	2000
BRR5140-SLY-A4	4415	1400	1940	2400
BRR6168-SLY-A5	5405	1400	1770	3000
BRR268-SLY-A1	2450	1200	1770	1600
BRR3102-SLY-A2	3105	1200	1770	1600
BRR4136-SLY-A3	3755	1200	1940	2000
BRR5170-SLY-A4	4415	1400	1940	3000
BRR6204-SLY-A5	5405	1400	1770	3200
BRR288-SLY-A1	2455	1200	1770	1600
BRR3132-SLY-A2	3105	1200	1940	2000
BRR4176-SLY-A3	3755	1400	1940	2350
BRR5220-SLY-A4	4750	1400	1770	3000
BRR6264-SLY-A5	5405	1400	1910	2800
BRR375-SMY-2	3105	1200	1770	2000
BRR4100-SMY-3	3765	1200	1940	2000
BRR5125-SMY-4	4415	1200	1940	2400
BRR6150-SMY-5	5405	1200	1770	3000
BRR390-SMY-2	3115	1200	1940	2000
BRR4120-SMY-3	3765	1200	1940	2000
BRR5150-SMY-4	4750	1200	1770	2400
BRR6180-SMY-5	5405	1200	1910	3000
BRR270-SMY-1	2455	1200	1770	1600
BRR3105-SMY-2	3115	1200	1940	2000
BRR4140-SMY-3	4100	1200	1770	2350
BRR5175-SMY-4	4805	1200	1990	3000
BRR6210-SMY-5	5405	1200	1990	2800
BRR280-SMY-1	2455	1200	1770	1600
BRR3120-SMY-2	3115	1200	1940	2000
BRR4160-SMY-3	4100	1200	1910	2350
BRR5200-SMY-4	4805	1200	1990	3000
BRR6240-SMY-5	5405	1200	1990	2800
BRR2100-SMY-1	2465	1200	1940	1600
BRR3150-SMY-2	3450	1200	1810	2000
BRR4200-SMY-3	4155	1200	1990	2350
BRR5250-SMY-4	4750	1200	1990	3000
BRR6300-SMY-5	5550	1200	1990	3600
BRR336-TLY	3700	1200	1800	1400
BRR348-TLY	3700	1200	1800	1500
BRR360-TLY	3700	1200	1800	1550
BRR390-TLY	3700	1200	1800	1600
BRR480-TLY	4450	1200	1800	1950
BRR4100-TLY	4450	1400	1800	2000
BRR4120-TLY	4450	1400	1800	2000
BRR5150-TLY	5250	1400	1800	2500
BRR6180-TLY	5950	1400	1800	2850

尺寸参数

型号 Model	EGTA.1R6	EGTA.24R6	EGTA.26R6	EGTA.28R6	EGTA.34R6	EGTA.36R6	EGTA.38R6	EGTA.44R6	EGTA.46R6	EGTA.48R6
供液管 Inlet	1" 1/8	1" 3/8	1" 3/8	1" 3/8	1" 3/8	1" 5/8	1" 5/8	1" 5/8	1" 5/8	1" 5/8
进出口 接管尺寸 Connections	1" 3/8	1" 5/8	1" 5/8	1" 5/8	2" 1/8	2" 1/8	2" 1/8	2" 1/8	2" 1/8	2" 5/8
净重 Net Weight	260	292	316	349	395	433	457	506	506	549

供液管尺寸说明：供液管仅为产品进出口尺寸，实际接管管径尺寸需按具体应用计算确定。
 Note: Liquid/vapor line dimension is for inlet/outlet line of product, please calculate connection line dimension according to your applicator.

尺寸图

Dimensions

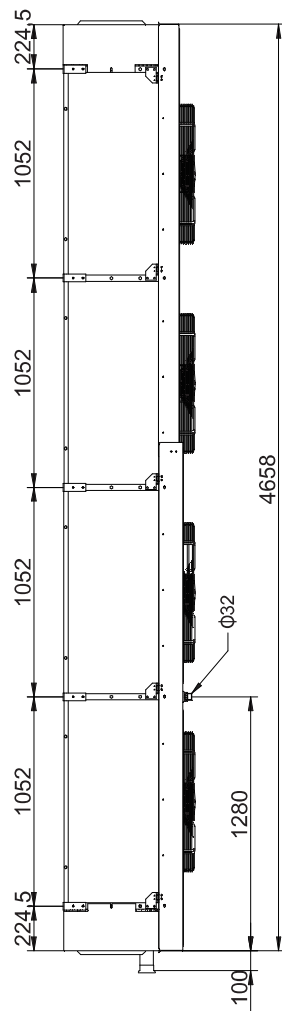
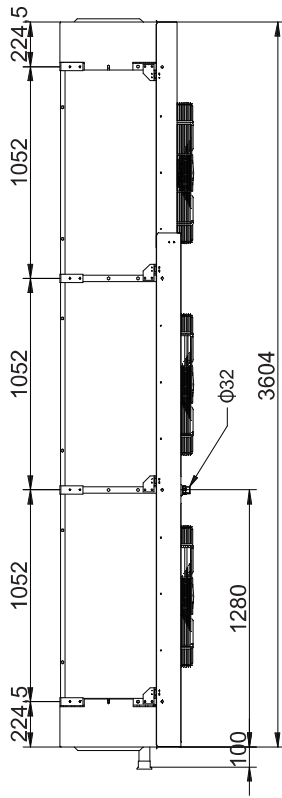
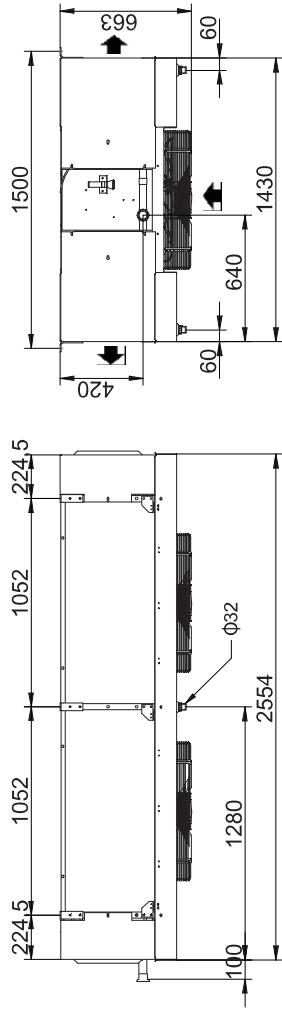

商用型风冷冷凝器

浮动盘管，灵活安装

WRC系列



177 --- 427KW



Commercial Condenser
 Floating Coil, Flexible Installation
 WRC Series

尺寸参数
Dimensions

型号 Model	尺寸参数 Dimensions				运输体积 Transport Volume	重量 (kg) Net weight	重量 (kg) w/ packing
	L	W	H	A B C			
单排冷凝器顶排风 Single row top ventilation condensers							
WRC098LN	3260	1250	1410	2750	—	6.7	410
WRC112LN	3260	1250	1410	2750	—	6.7	430
WRC119LN	3260	1250	1410	2750	—	6.7	460
WRC123LN	3260	1250	1410	2750	—	6.7	500
WRC147LN	4660	1250	1410	4150	2775	1375	560
WRC167LN	4660	1250	1410	4150	2775	1375	610
WRC178LN	4660	1250	1410	4150	2775	1375	660
WRC185LN	4660	1250	1410	4150	2775	1375	710
WRC198LN	6068	1250	1410	5550	2775	—	740
WRC225LN	6068	1250	1410	5550	2775	—	820
WRC240LN	6068	1250	1410	5550	2775	—	890
WRC247LN	6068	1250	1410	5550	2775	—	960
WRC297LN	7469	1250	1410	6950	2775	1400	1130
WRC307LN	7469	1250	1410	6950	2775	1400	1210
单排冷凝器侧排风 Single row side ventilation condensers							
WRC098LN	3260	1136	1250	2750	—	6.7	410
WRC112LN	3260	1136	1250	2750	—	6.7	430
WRC119LN	3260	1136	1250	2750	—	6.7	460
WRC123LN	3260	1136	1250	2750	—	6.7	500
WRC147LN	4660	1136	1250	4150	2775	1375	560
WRC167LN	4660	1136	1250	4150	2775	1375	610
WRC178LN	4660	1136	1250	4150	2775	1375	660
WRC185LN	4660	1136	1250	4150	2775	1375	710
WRC198LN	6068	1136	1250	5550	2775	—	740
WRC225LN	6068	1136	1250	5550	2775	—	820
WRC240LN	6068	1136	1250	5550	2775	—	890
WRC247LN	6068	1136	1250	5550	2775	—	960
WRC297LN	7469	1136	1250	6950	2775	1400	1130
WRC307LN	7469	1136	1250	6950	2775	1400	1210

单排冷凝器顶排风
Single row top ventilation condensers

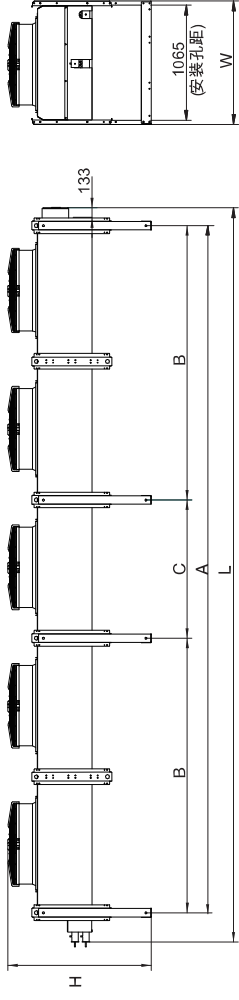

单排冷凝器侧排风
Single row side ventilation condensers

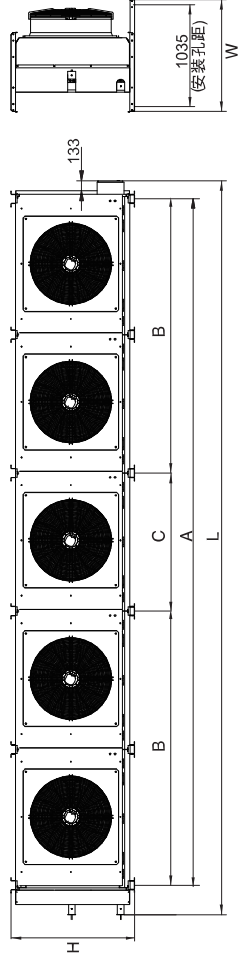

修正系数
Correction Factors

环境温度修正系数 (K1) Ambient correction factors	
环境温度 °C Ambient temperature	15
系数 Factor	0.979
	20
	25
	30
	35
	40
	45
	1.008
	1.003
	0.998
	0.992
	0.986
	0.979

海拔高度修正系数 (K2) The altitude correction factors	
海拔 (m) Altitude	0
系数 Factor	1
	1.04
	1.06
	1.075
	1.09
	1.11
	1.12
	1.008
	1.003
	0.998
	0.992
	0.986
	0.979

内部过冷修正系数 (K3) Internal sub-cooling correction factors

过冷度 K Subcooling	冷凝温差 KTD Condensing temperature difference KTD				
	3	5	10	15	20
2	0.966	0.976	0.989	0.994	0.996
4	—	0.934	0.975	0.986	0.990
6	—	—	0.946	0.972	0.980
8	—	—	0.898	0.960	0.966

*内部过冷指的是使用标准盘管设计达到一定的过冷度。
*Internal sub-cooling refers to using standard coil design to reach certain sub-cooling degree.

翅片型式修正系数 (K4) Fin correction factors	铝翅片 Aluminum	1.00	蓝色铝翅片 Blue fin	0.995
---	-----------------	------	-------------------	-------

所需冷凝器的标准散热量
Required condenser standard THR = $\frac{K2}{K1 \times K3 \times K4}$ × 所需散热量
required capacity