

CỬA CUỐN CÔNG NGHIỆP

INDUSTRIAL ROLLING SHUTTER

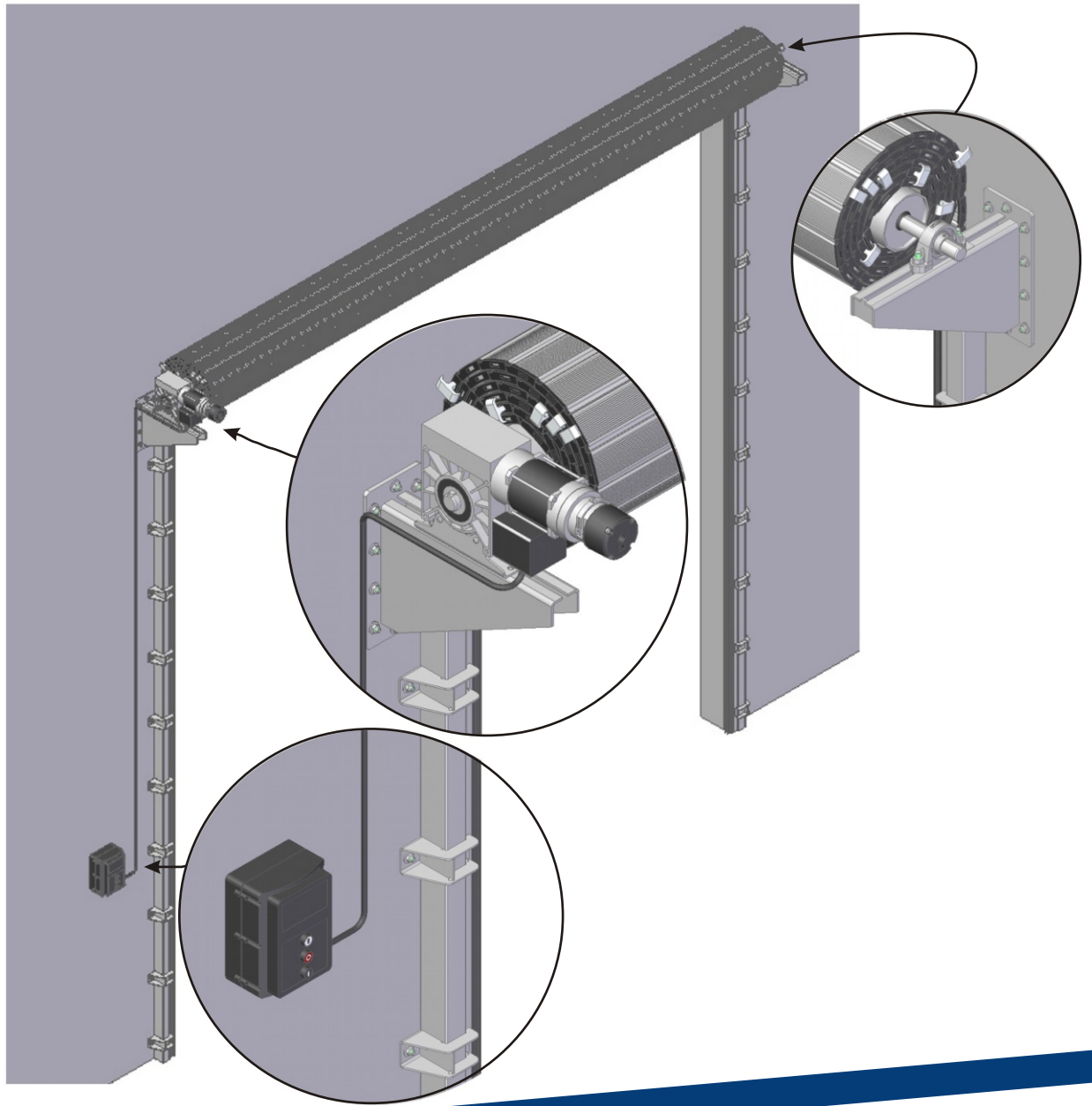

Nov
2015

INDUSTRIAL ROLLING DOOR

Inserting the roll into the guides

10.1

Put the roll with the end aluminium profile to the position shown in the figure, by manual operation of the drive

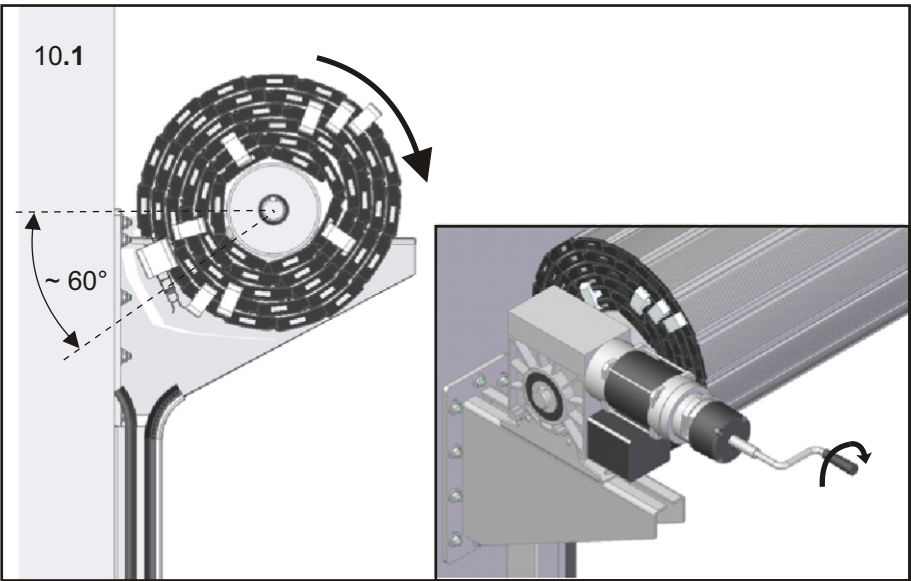

10.2

Remove the tapes from both sides of the roll and insert the curtain into the guides, by manual operation of the drive, until the half height of the guides

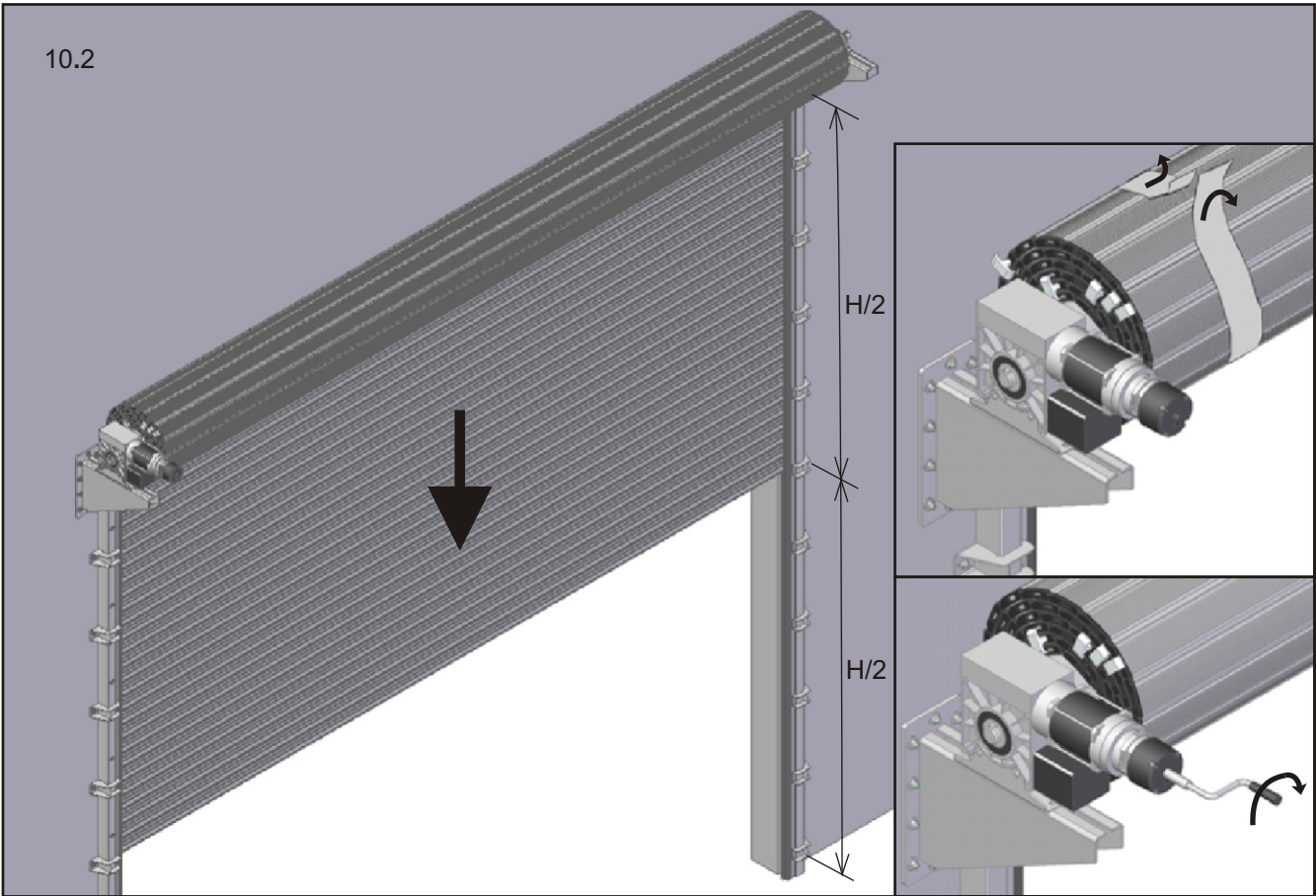

INDUSTRIAL ROLLING DOOR

Inserting the roll into the guides

11.1 & 11.2

With the roll closed until the half height of the guides check the introduction of the roll into the guides and adjust if necessary (front or rear) the position of the drive and the bearing on the supports

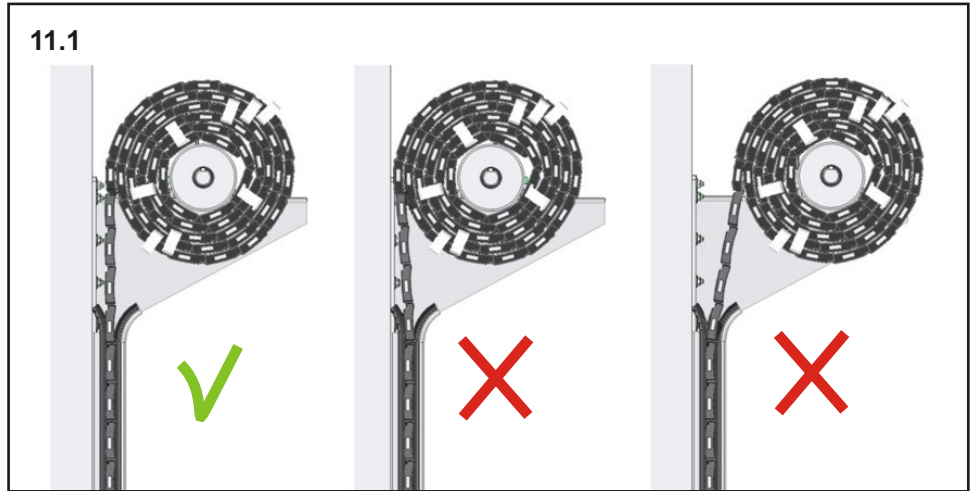

11.3

Place the roll so that their ends have equal distances from the bottoms of the guides

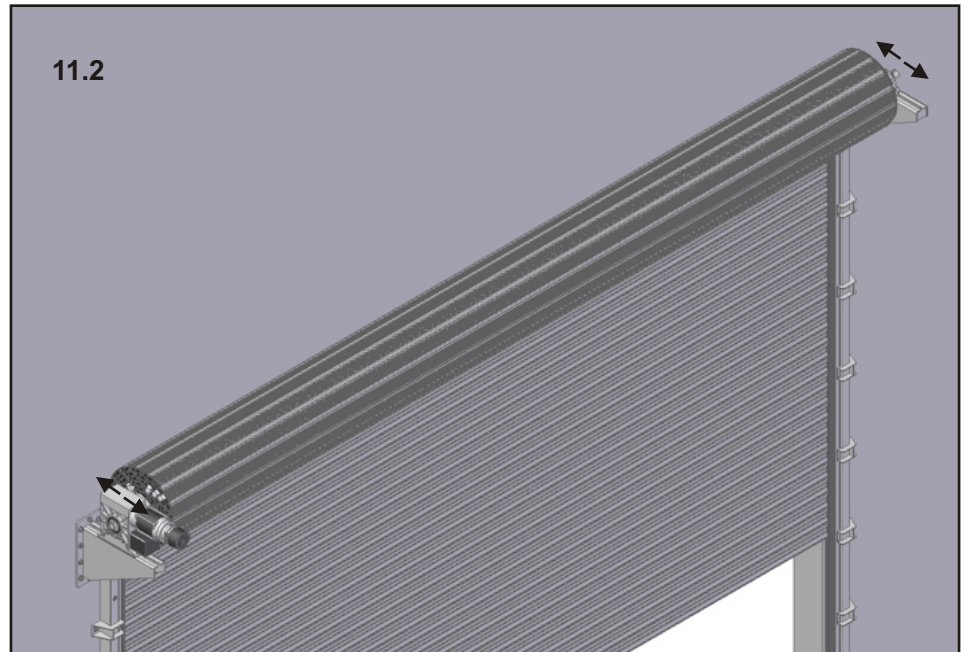

11.4

Tighten the screws on the bearing

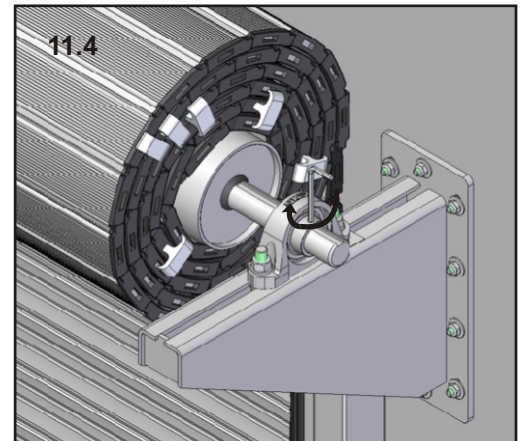
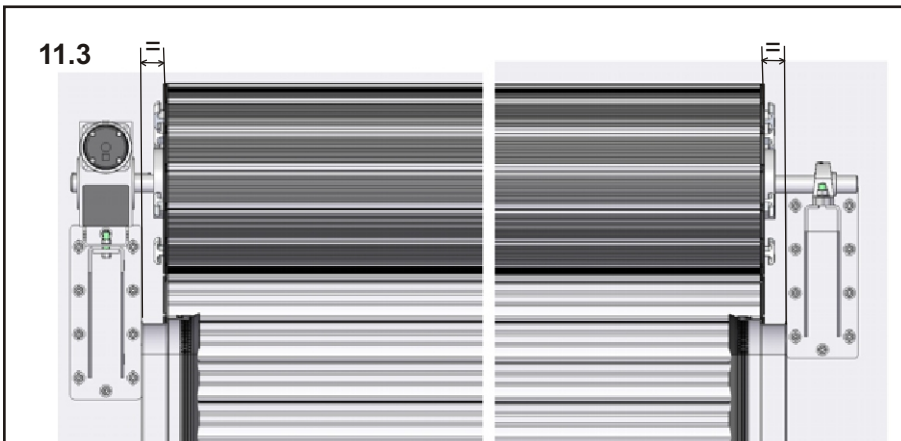

INDUSTRIAL ROLLING DOOR

Connecting the drive - Adjustments

12.1

Connect the drive to the control panel following the instructions of the manufacturer.
Connect all the limit switches and the safety devices.
Connect to the mains

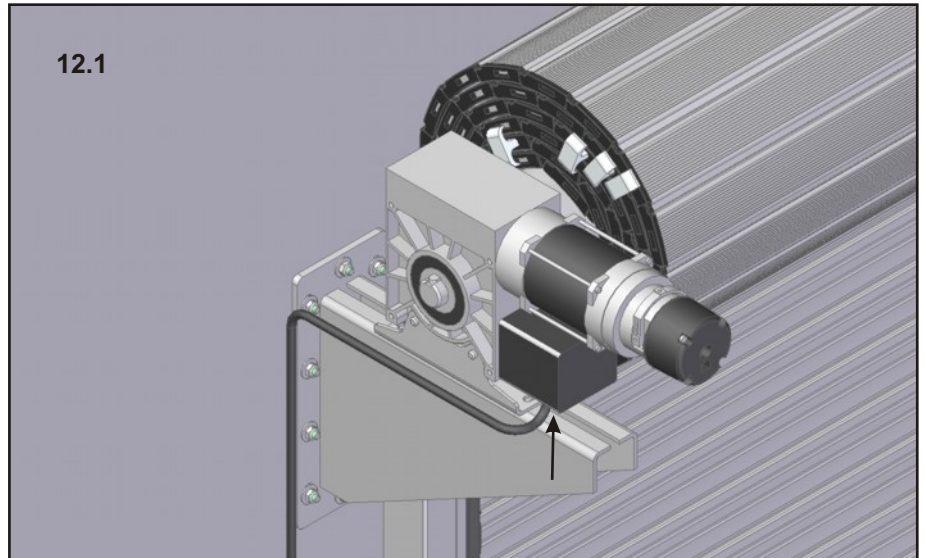

12.2

Adjust the OPEN position so that the curtain of the roll do not move out from the guides

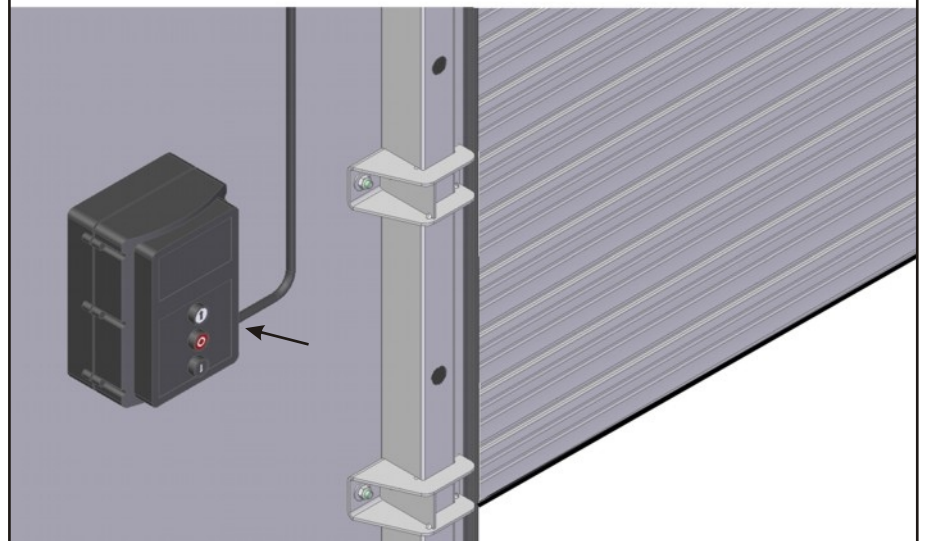

12.3

Adjust the position CLOSE so that the curtain of the roll not deformed and the end aluminium profile not pressed too.

